

THE LINE



Site: Roanoke, Virginia

A city with a rich railroad history, the site is located near the convergence of multiple railroads in Roanoke, Virginia. Each night, about 300 people in the city must resort to alternative housing facilities to stay off the streets (Homeless Assistance Team). (Left Photo: Carlson)



Design Statement

The space takes inspiration from the **railroad tracks** that run through **Roanoke**, Virginia, as they are symbolic of **moving forward** and the ever-changing destinations of life. Everyone moves through life at a different speed, taking different pit stops before they arrive at their **final destination**. We want to incorporate this idea into the basic needs shelter by using the railroads of Roanoke to both organize the space and emphasize a **sense of direction**, movement, and guidance throughout their time of **transition** from one destination to another. The railroads' movement through the **Blue Ridge Mountains** are representative of **perseverance** through a rough landscape, through the incorporation of related materials, natural elements, and clear **wayfinding** in the space.

Experiential Research

In early October, we had the opportunity to visit Roanoke's Rescue Mission, a homeless shelter in Southwest Virginia. Upon our visit we had the chance to tour the entire space and meet with some of the Mission's employees. We left with the conclusion that people entering these spaces come from diverse backgrounds and stories, therefore it is extremely important to provide them with an environment where they never feel impoverished.

In order to eliminate intimidation among those entering, the space should have clear, obvious wayfinding and should avoid an institutional feel. The goal is for users to feel comfortable in the space, but not too comfortable as they should always remember that their situation is only temporary. Above all, the space should be bright and uplifting, to inspire those who need it the most.

Feature Piece

Skylights in the space follow the main circulation path and filter natural light. When light passes through the skylights, it creates linear patterns and shadows on various wall and floor surfaces. This results in a dynamic visual that is an abstract representation of simplified forms drawn from railroad construction.

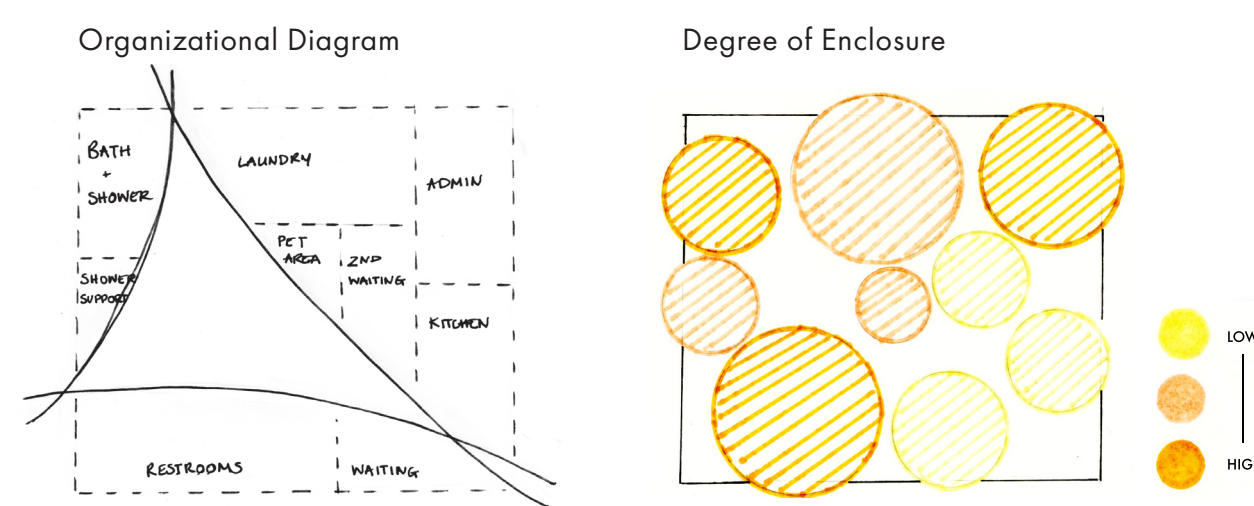

Path

Circulation converges and branches off in a similar manner to the railroad lines that run through Roanoke.

Volume

A mass hovers above the path to create a sense of enclosure and wayfinding for guests.

Divide

Voids in the mass filter natural light in the daytime. Artificial lighting is diffused from within the voids at nighttime.

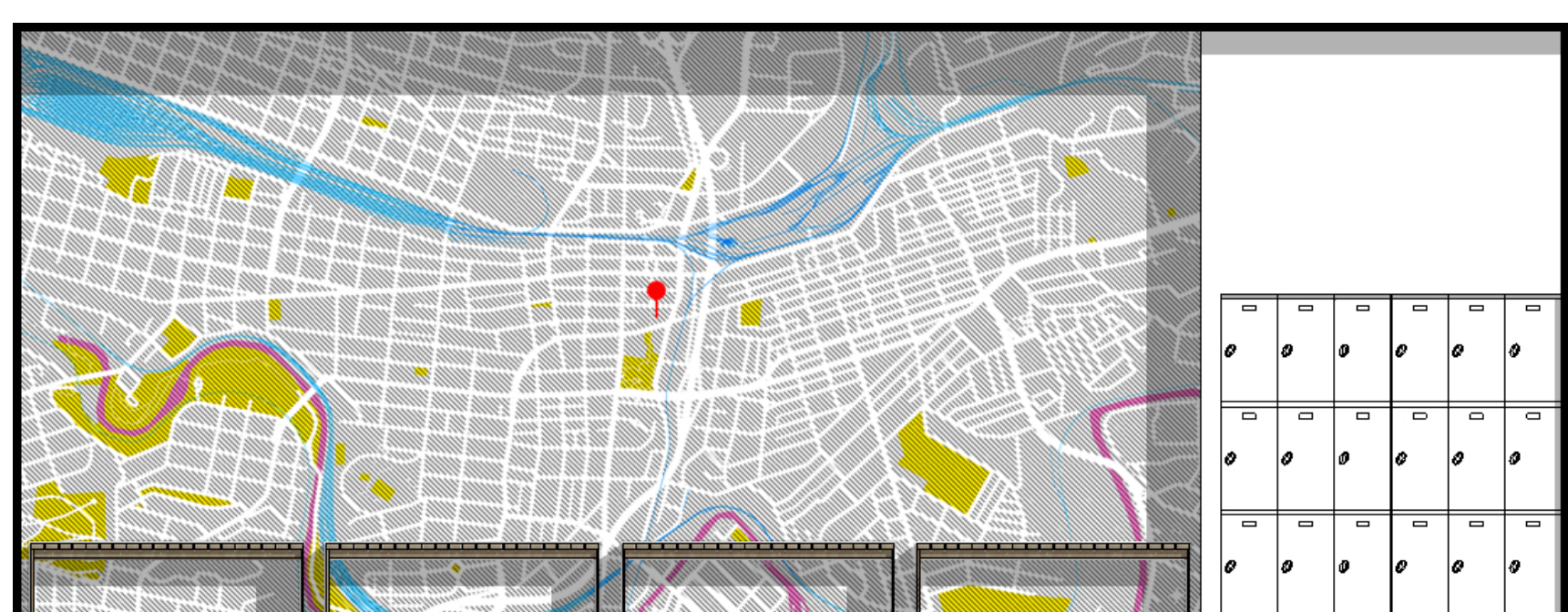

Interior Elevation NTS

A graphic wall featuring a map of Roanoke is located along a pathway that runs parallel to the south curtain wall. This graphic is meant to provide a sense of place and connection to community for guests and people passing by.



Reception
The reception area is located at the intersection of the main three paths, forming a central datum point that is highly visible from multiple locations. This provides wayfinding for the user as they are first introduced to the space or travel from stop to stop within the space.



Waiting Area
Upon entrance to the building, users are first introduced to a casual open waiting area and coffee bar. This provides visitors with a comfortable and welcoming interruption before they head over to the reception desk or other stops further along the way.



Inside Laundry Room



Hallway + Laundry Area

The laundry area is located toward the back of the building and is equipped with a waiting area oriented in a similar fashion, allowing users to have the choice to wait for their clothing while simultaneously having a view to the outside. An LED light that says "Trust Your Journey" is mounted on the far wall and contributes to the uplifting atmosphere. A folding table is located in the center of the laundry area to promote clear circulation and little visual obstruction throughout the space. Bright yellow and a linear design wallpaper is used to brighten up the space and add a playful aspect.



Floor Plan
SCALE: 1/8" = 1'-0"

- | | |
|-----------------------|--------------------------|
| 01. Entrance | 11. Pet Area |
| 02. Locker Area | 12. Director's Office |
| 03. Quiet Waiting | 13. Admin Open Office |
| 04. Open Waiting | 14. Admin Kitchen |
| 05. Reception | 15. Manicure Station |
| 06. Restrooms | 16. Laundry Room |
| 07. Janitorial Closet | 17. Lounge Seating |
| 08. Shower Support | 18. Small Group Seating |
| 09. Shower Area | 19. Large Group Seating |
| 10. Coffee Station | 20. Children's Play Area |



Outdoor Space

Visitors are directed through each "stop" on their voyage through the basic needs shelter along a circulatory path that represents a rail line. This path offers a sense of clarity to the user due to lighting and color techniques. Skylights provide wayfinding along the main circulation path, while yellow wallcovering points users toward key stops along the way. At the end of the path, visitors arrive at the outdoor patio. Clear circulation, a variety of seating, and the presence of plants and shade make for an inviting and restorative area.

Lighting



iLight Technologies Plexineon LED sign
Lightolier Lyte Profile LED
Intra Lighting Night + Day
Fontana Arte Huna Pendant

Materiality



Shaw Contract Check Carpet Tile
Existing Floor Polished Concrete
Shaw Contract Sheet Flooring
Shaw Contract Engineered Wood
Pantone 7405 C Wall Paint
Maharam Wallcovering
Designtext Canary Textile
Kovi Faux Leather

Linear elements mimic simplified forms drawn from railroad tracks. The color yellow and other warm tones are used to curate an uplifting environment. Materiality of the space as it relates to woods, metals, and leather is inspired by the woods, metals, and industrial look of railroads and their respective railway stations.

Front Elevation
SCALE: 1/8"=1'-0"

The name of the basic needs shelter was derived from the concept of the railroad "line". This logo, constructed of wrought iron, draws from the industrial nature of Roanoke and contrasts with the white-painted CMU facade.

