

Partners: Shared Spaces Portland considers guests of the facility to be "Partners" because members of the community are an essential part of lowering the heat island effect.

Concept Statement

A sustainable, lively, and engaging space that educates about interior designers and their work will be created. The space, in downtown Portland, will be an example of how sustainable interior design can influence ecology and community. Using green techniques and practices such as daylight harvesting; solar, wind, and hydroelectric energy harnessing; and implementation of sustainable materials and finishes, Shared Spaces Portland will work with the community to lower carbon emissions and reduce the heat island effect in Portland. An open plan, versatile furniture, and the integration of technology will help partners meet, learn, and collaborate for the community. Durable and sustainable, yet aesthetically pleasing materials and finishes will be used throughout the facility to promote learning of Shared Spaces mission.

Spaces to be designed include: Lobby, Information Center, Waiting area, Community Meeting spaces, Community Learning spaces, an Open Studio Space, Multi-Person Faculty Offices, a Gallery Space, Touchdown Areas throughout, and support spaces such as Restrooms and Supply Closets.

Portland Primary Climate Risks

Hotter Summers High-Heat Days



Risk 1: Increased temperatures and frequency of high-heat days



Risk 2: Increased incidence of drought



Risk 3: Increased wildfire frequency and intensity

Warmer Winters Intense Rain Events



Risk 4: Increased incidence and magnitude of damaging floods



Risk 5: Increased incidence of landslides

Figure 1. Climate Risks of Portland.

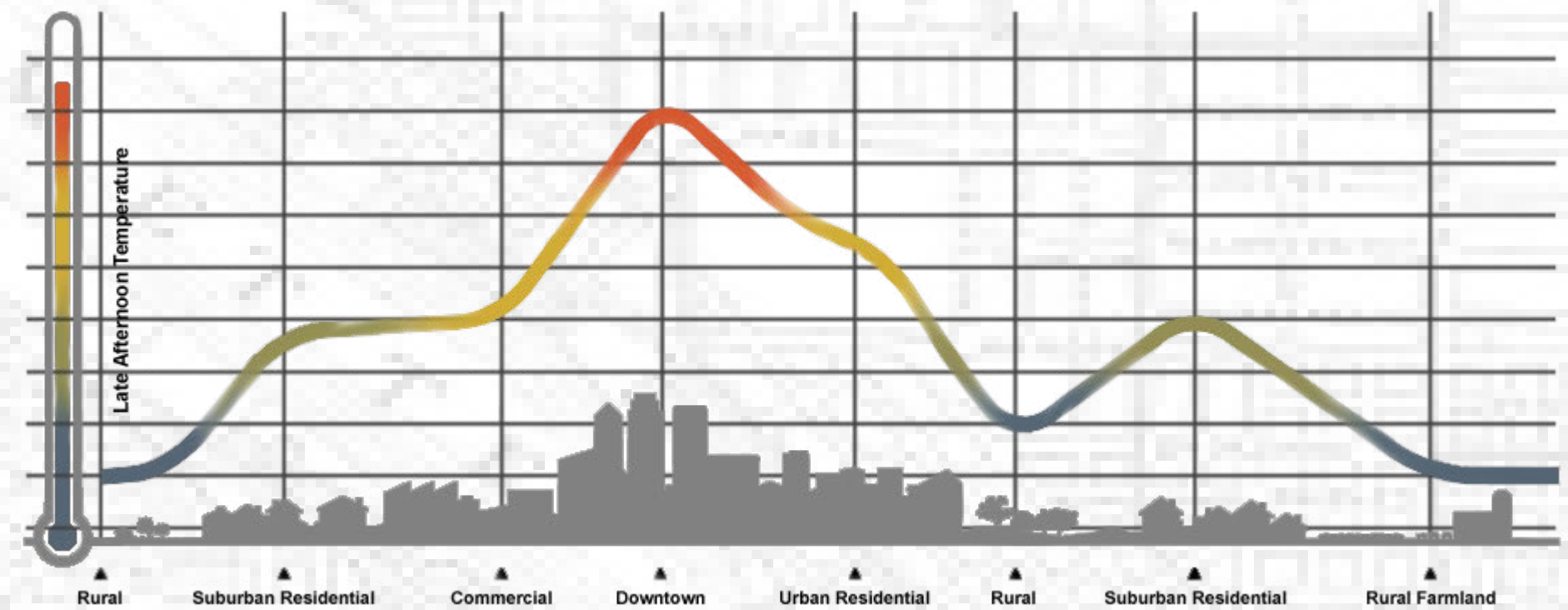

Figure 1. This graph shows the relation of temperature to density of Portland population.

The Art Institute Analysis

Shared Spaces is proud to partner with The Art Institute, an internationally known system with over 50 schools across North America. They offer master's, bachelor's, and associate's degree programs in multiple art based majors including one of the best interior design programs in the country. They provide relevant, hands-on, and practical education. They focus on professional development and are an excellent partner for Shared Spaces Portland. Because of its international recognition as well as its involvement with multiple communities across the United States, The Art Institute was selected as the partner school to fulfill the vision of Shared Spaces Portland, creating a healthier life and healthier world.

Portland Location Analysis

Portland, Oregon ranks as number 4 in the nation for worst heat island effect (Kenward, 2014, p. 2). Portland can get up to 19°F hotter in the city than in nearby rural areas and in the summers there is an annual increase of 4.8°F hotter in the city compared to rural areas (Kenward, 2014, p. 2). Portland residents also have a global reputation for their green preferences. Portland has one of the most impressive recycling programs in America and is constantly striving for sustainability and therefore the perfect city to implement the Shared Spaces Portland Initiative.

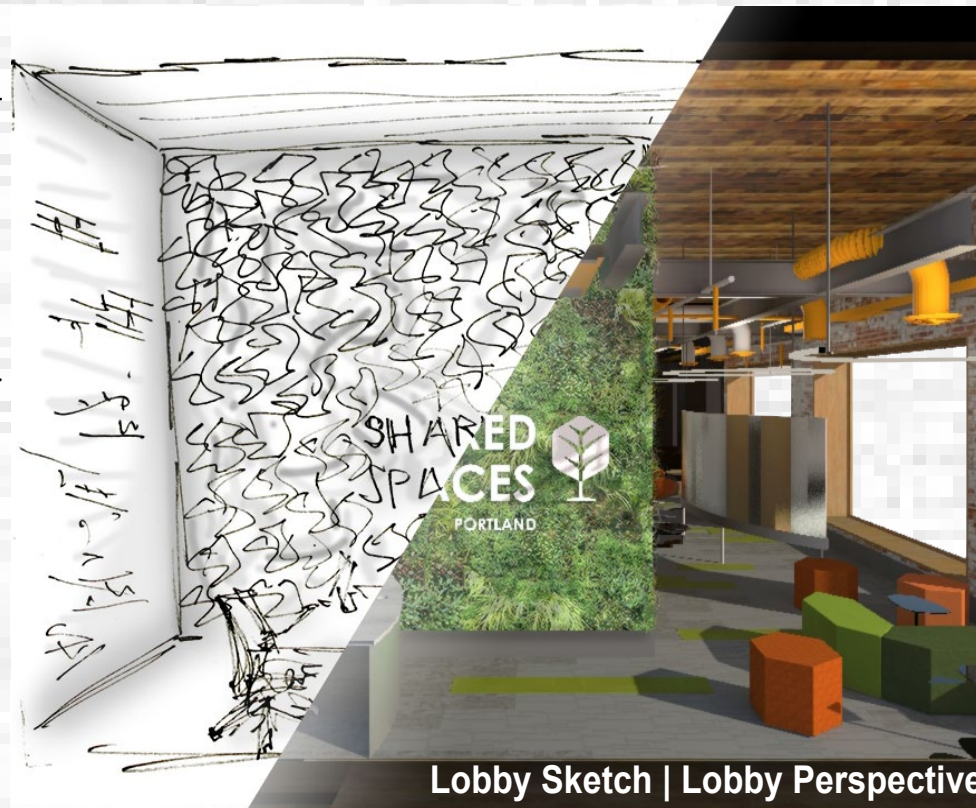

Lobby Sketch | Lobby Perspective



2nd Level Perspective



Buildings and Energy

By renovating old construction and creating sustainable and ecologically sound new construction, Shared Spaces Portland will incorporate systems that will limit carbon emissions. This will cause Portland to flourish as an international leader in lowering the urban heat island effect. By teaching the community about the heat island effect Shared Spaces will be able to incorporate Portland's 2030 Climate Action Plan while simultaneously weaving the community and surrounding neighborhoods together to produce renewable resources and achieve zero-net carbon emissions in all new construction (Allaway, 2013, p. 58-69).



Urban Forest

The implementation of the 2030 Portland Climate Action Plan will emphasize sequestering carbon through the increase of natural elements and green infrastructure. Designing with nature through urban design, and redevelopment approaches to architecture and interior design like adopting ecoroofs, and assimilating vegetation into design, Shared Spaces Portland will aid in community health and ecological well-being (Allaway, 2013, p. 102-105).

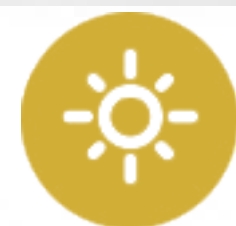

Climate Change

The heat island effect is continuously creating a detrimental health issue that may spread from urban heat islands to surrounding suburban and rural communities. Reducing the carbon emission of major cities like Portland may aid in the lowering of heat and subsequently reducing risks and impacts from heat, drought, and wildfire. By joining the community with an international school, The Art Institute, Shared Spaces will implement Portland's Climate Action Plan World Wide ultimately changing the climate and aid in the universality of international sustainable communities (Allaway, p. 106-117).



Community

By informing communities about the development and implementation of climate change issues by incorporating educational aspects as well as meeting opportunities, the Shared Spaces of Portland Oregon will enrich surrounding neighborhoods to foster commitment to Shared Spaces. Accessibilities for under-represented and under-served populations will be created through making available some of the most cost-effective, healthy, and easy solutions (Allaway, 2013, p. 118-123).



1st Level Perspective

References

Allaway, D. (2013, July 11). Climate Action Plan. Retrieved August 31, 2015, from <http://www.portlandoregon.gov/bps/article/531984>
 "Environmental Guide." HighTower. 2015. Web. 21 Aug. 2015.
 "Interface | Commercial Modular Carpet Tile | What Inspires You?" Interface | Commercial Modular Carpet Tile | What Inspires You? 2015. Web. 12 Sept. 2015.
 "Shaw Contract Group - Commercial Carpet and Commercial Hardwood Flooring." Shaw Contract Group - Commercial Carpet and Commercial Hardwood Flooring. 2015. Web. 12 Sept. 2015.

Table of Figures

Figure 1: Allaway, D. (2013, July 11). Climate Action Plan. Retrieved August 31, 2015, from <http://www.portlandoregon.gov/bps/article/531984>
 Figure 2: Allaway, D. (2013, July 11). Climate Action Plan. Retrieved August 31, 2015, from <http://www.portlandoregon.gov/bps/article/531984>

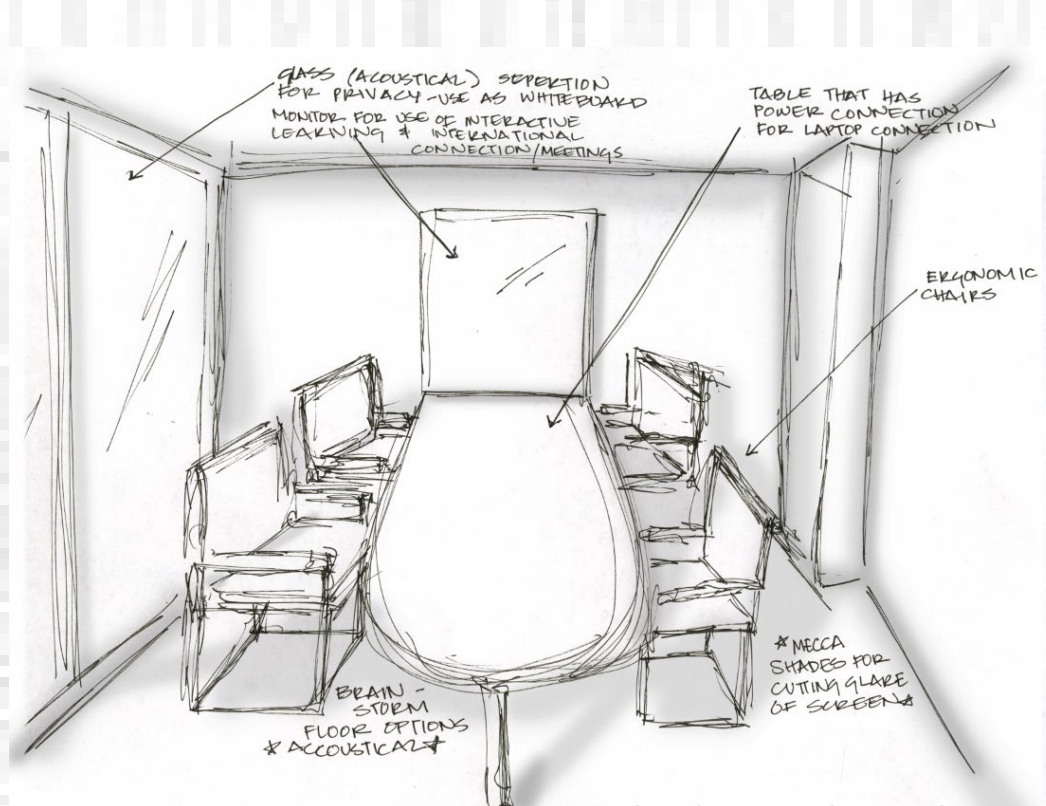

Tele-Conference Space Sketch

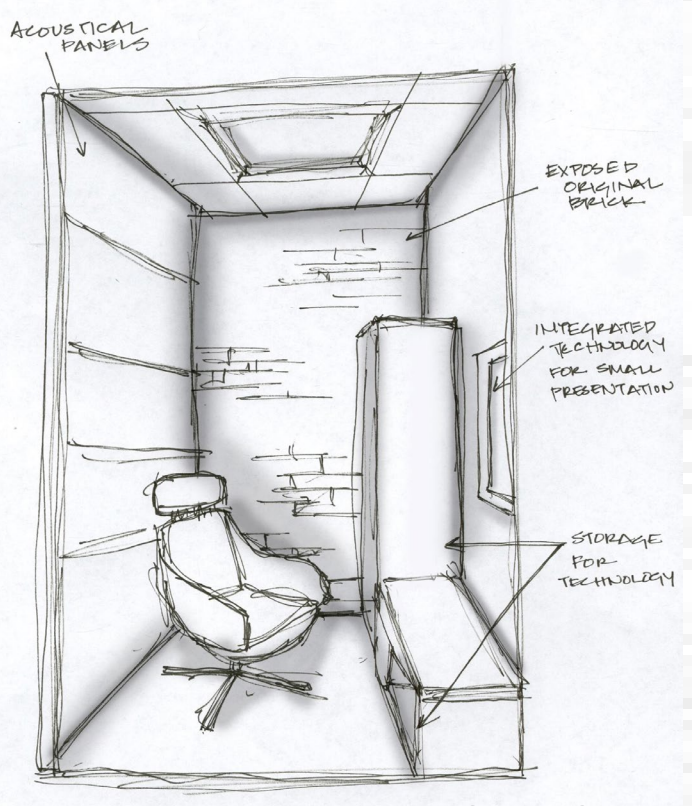

Private Meeting Space Sketch

Flatfrog:

An interactive display that promotes learning by engaging community members, Flatfrog is one of the most advanced pieces of technology offered by Shared Spaces Portland. This large, multi-touch (80 points) display allows multiple users to interact and discover new information about Portland and its heat island effect. Sustainability factors include lower power outputs, recycled glass and plastic content within the display, and a durable, rugged design.

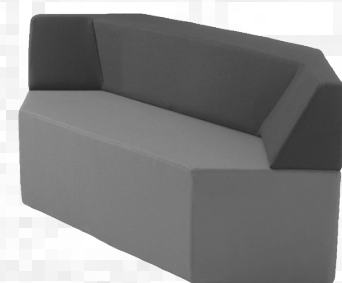

High Tower Prism



Coalesse Bob Table

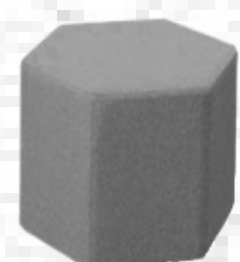
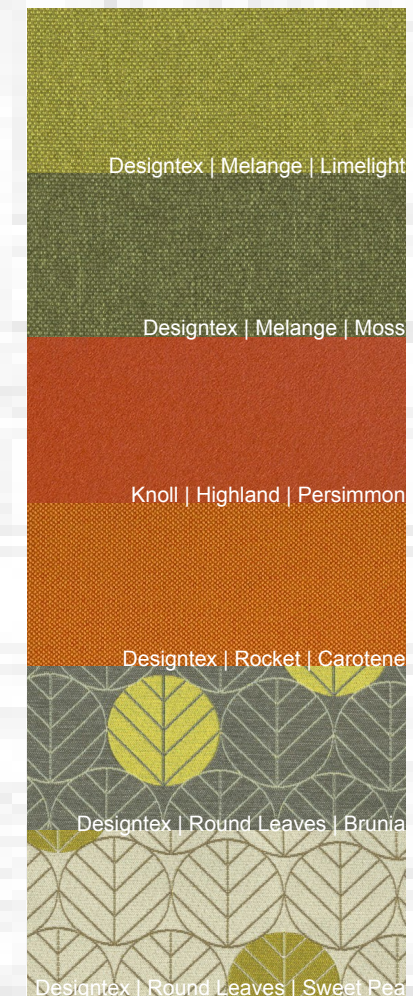
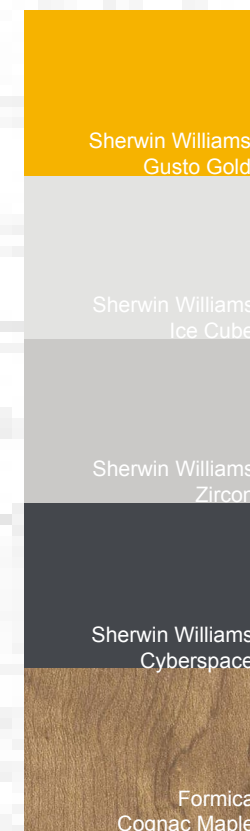

High Tower Prism Honeycomb



Coalesse Bob



Herman Miller Sayl



Herman Miller Meridian



Allermuir Jaicer



Herman Miller Steelwood

FF&E Sustainability Factors

- Furnishings:**
- Prism Collection | Hightower – Local Materials, Low VOC's, FSC Certified, & ISO 14001 Certified Factories
 - Bob Collection | Coalesse – SCS Indoor Advantage, Level 1 Certified, 11% Recycled Content, & 75% Recyclable
 - Sayl Chair | Herman Miller – Cradle to Cradle Silver, 8% Recycled Content, & 91% Recyclable
 - Meridian Collection | Herman Miller – Level 2 & 3 Certification, FSC Certified, GreenGuard Certified, 33% Recycled Content
 - Jaicer Stool | Allermuir – FSC Certified, 99% Recycled Content, 100% Recyclable
 - Steelwood | Herman Miller - Greenguard Gold Certified, FSC Certified, 0 PVC
- Paints & Finishes:**
- Sherwin Williams Paints – Low VOC emissions, Long Lasting, & Fade Resistant
 - Plastic Laminates – Formica – Low VOC Emissions, Carbon Reduction, FSC Certified, LEED Contribution
- Flooring:**
- Interface – Reduced Carbon Emissions, No Glue Flooring, Recycled Content
 - Shaw – Reduced Carbon Emissions, No Glue Flooring, Recyclable Content
- Textiles:**
- Knoll – Cradle to Cradle Certified, Up to 75% Recycled Content, LEED Contribution, Reduced Carbon Footprint, Easily Cleanable
 - Designtex – Cradle to Cradle Certified, FSC Certified, Up to 50% Recycled Content, LEED Contribution, Durable, Easily Cleanable



2nd Level Rendered Floor Plan



1st Level Rendered Floor Plan

Community Meet

Community Meet Space is extremely pivotal in the inclusion and education of the surrounding neighborhoods. Meeting space is versatile, just like every area in Shared Spaces facility, and is able to transition from an everyday touchdown setting to special event seating. Because of the open plan that is incorporated through the lower and upper floors of Shared Spaces Portland, there are multiple uses for each area. The Community Meet space works closely with the Community Learn area and they are able to transition to use the same technology for educational presentations, CEUs, or public meetings. Shared Spaces Portland teaches through collaboration.

Community Learn

The Shared Spaces Community Learn space is outfitted with all of the latest interactive technology termed FlatFrog. FlatFrog is multi-touch so that multiple partners can learn about the heat island effect and about how interior design can aid in the lowering of carbon emissions, energy consumption, and the increased health of surrounding ecological and human related health. Shared Spaces Portland incorporates the Community Learn aspect in our Energy Room where the Center showcases the innovative and sustainable energy initiatives taken to create an energy efficient Community Center and teach alternative energy solutions. Shared Spaces Portland teaches through technology.

Community Greet

A large vegetation wall welcomes partners as they enter Shared Spaces, closely followed by the welcoming smile of the receptionist located to the left. A waiting area/touchdown space is located toward the right and is available for use by waiting clients or community members. The reception desk doubles as an information center while part-time workers are unable to man the station at all hours. The vegetation wall is not only signage, it is an example of how interior design may help curtail the carbon levels and volatile organic compounds. Shared Spaces Portland teaches through example.

Community Work

Second Level of Shared Spaces is home to the studio where local high schools and The Art Institute undergraduate/graduate students are able to come and partner to work toward community involvement and a common goal. This space is completely versatile and gives students multiple options for collaborating and also provides integrated power stations. Different types of seating is provided for comfort of multiple partners personal preferences. The studio space is also versatile in that it is moveable and has storage for materials and supplies. Mixtures of experience and raw talent mix in this area and create a Shared Spaces Portland that teaches through partnership.



References

- Coalesse. (2015). Products. Steelcase.
- DesignTex. (2015). Products. Steelcase.
- Formica. (2015). Products. Formica.
- Herman Miller. (2015). Products. Herman Miller.
- Hightower. (2015). Products. HighTower.
- Interface. (2015). Products. Interface.
- Knoll. (2015). Products. Knoll.
- Shaw. (2015). Products. Shaw.
- Sherwin Williams. (2015). Products. Sherwin Williams.