

# FINDING ADEY ABEBA

- Hope and new beginnings

Adey Abeba is a sanctuary space for refugees to seek shelter and rest at the midpoint of their journey towards refuge in Sudan. Adey Abeba is the national flower of Ethiopia; symbolizing hope and new beginnings. The concept communicates to the users that there is still hope for a new life, even with the hostilities of the outside world. This space provides a sense of safety, community, and familiarity to the refugees as they partake in their grueling journey away from their homes - into a foreign place where familiarity and home seems so far away

## The Story

An Ethiopian family flees from the Tigray region as the civil war surges forward. The family consisting of a mother, father, and their two children fled their homes as their neighborhood was under siege by federal forces. The family must partake in this grueling journey on foot before crossing the Tekeze River to get to the Sudan border. To cross the river, the family piles into overcrowded rafts filled with many refugees with similar stories to theirs. Once they cross, they begin their journey towards the neighboring town of Hamdayet - this grueling 4 day journey has left the family exhausted and famished. The family travels on foot for 15 more minutes before reaching sanctuary at Adey Abeba

## The Problem- Ethnic Massacre

Since 2020, the region of Tigray in Northern Ethiopia has become the center of a civil conflict between the current Ethiopia government led by Abiy Ahmed and Tigray People's Liberation Front (TPLF), the main political party of Tigray, and who made up the former government of Ethiopia. What started out as a military operation became a targeted attack on the Tigrayan people and other ethnic groups

## Ethiopian Culture

Ethiopians are generally united by their patriotism and pride in the country's overarching cultural identity. The customs of Ethiopia continue to be deeply rooted in centuries of practice, and many aspects of daily life are ritualised. For example, there is a correct and traditional way to serve coffee, fold a dress, cut chicken and greet people. The country also has its own ancient alphabet and calendar that are still in use

## Principles & Goals



**Safety**  
Provide a space that allows families to seek refuge from the hostilities of the outside world



**Connection**  
Allow refugees to find a sense of community within one another while on their journeys to their final destinations



**Familiarity**  
Providing a sense of culture and a space that feels like home

## Color Palette

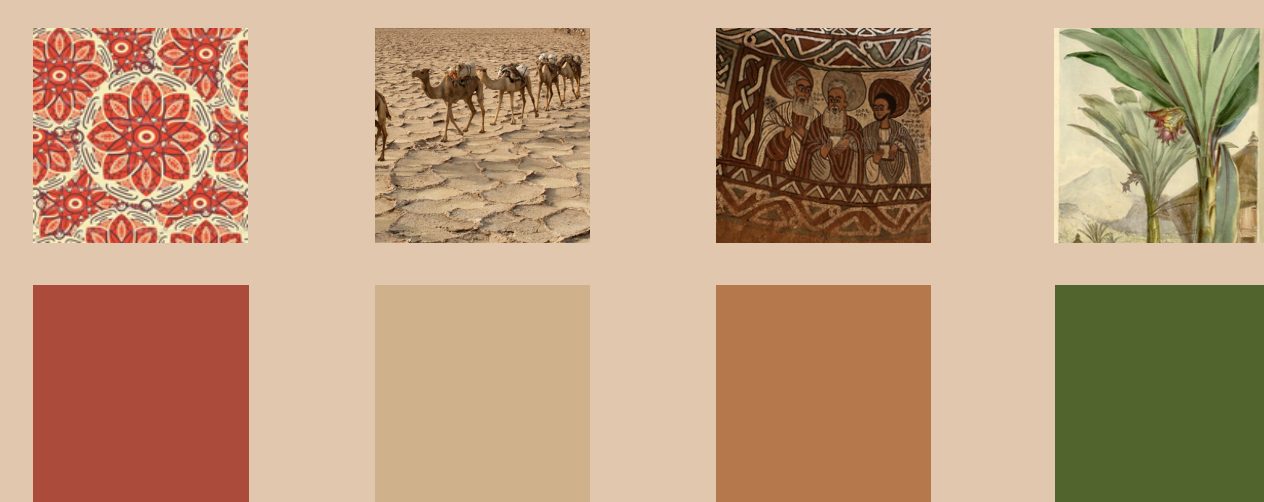

References  
<https://www.unref.org/en/operations/ethiopia/>  
<https://www.rescue.org/country/ethiopia>  
<https://www.rescue.org/article/crisis-ethiopia-climate-change-meets-conflict>  
<https://www.rescue.org/report/watchlist-crisis-alert-unnatural-disasters-crisis-alerts>  
<https://africanews.com/2022/02/22/ethiopia-situation/>  
<https://www.worlddata.info/africa/ethiopia/sybm.php?cexs=4%20C&f=c&popul&inf&form&cat&th&popul&lib&res&sub&stat&C&sc&ml&ta&on&sa&Y&men>  
<https://africanews.com/2022/02/22/ethiopia-situation/>  
<https://www.unref.org/ethiopia-refugees-in-sudan-a-briefing-note-to-the-ambir-and-un-ohchr-on-the-human-rights-situation-of-ethiopian-refugees-in-sudan/>

The color palette takes different aspects of Ethiopian culture and the natural land to bring a sense of familiarity to the space. The red color is taken from traditional patterns found across the regions. The sand/beige color represents the earth. The brown is taken from traditional Ethiopian paintings, and the green is derived from the ensete ventricosum, which is the Ethiopian banana plant

## Construction Materials



The materiality of the space is derived from local and readily available materials. To bring a sense of familiarity to the users, Adey Abeba resembles the local homes of the rural regions in Ethiopia. The use of mud or mortar and thatching for roof materials allows the users to feel that sense of familiarity that is often lost during the journey of the refugees

## Public V.S. Private

Public Space Private Space

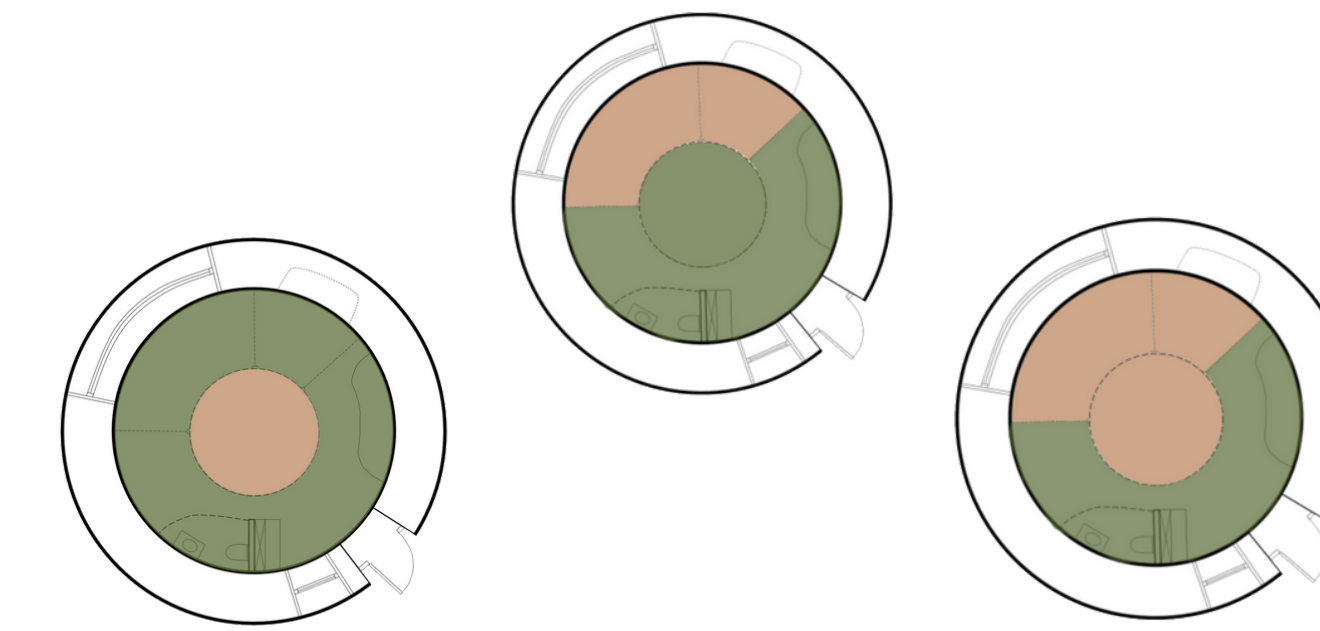

3D Section

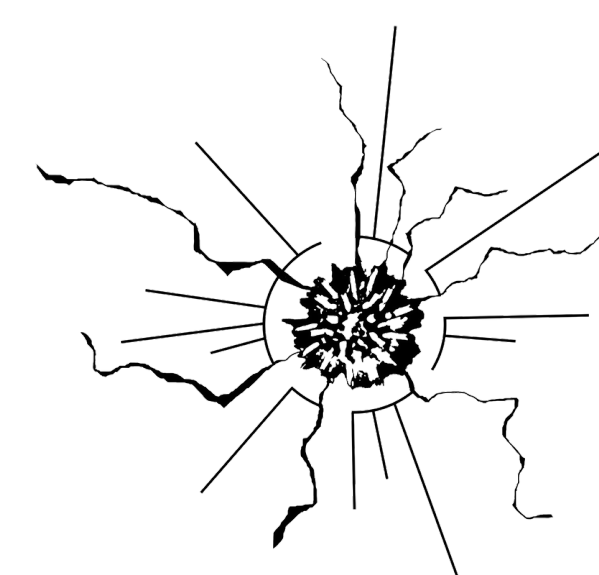
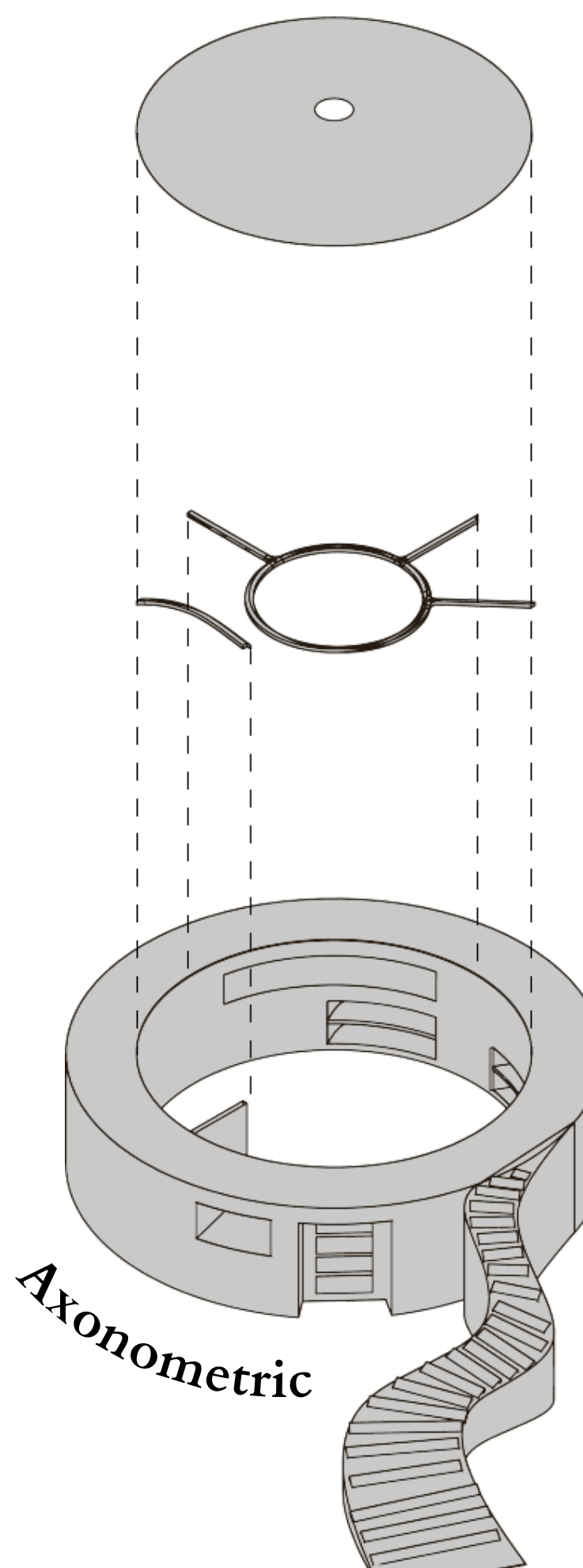

## PARTI

The parti takes several different parts of our concept, creating a diagram that represents new connections that lead to new beginnings. The center represents the center of an Adey Abeba flower to symbolize hope. The straight lines represent the paths the refugees take to their new lives, and the jagged lines are representational of the earth from Ethiopia and Sudan

## Building Strategies

- Low-tech constructive systems that can be built by workers of all levels of skills
- Using resources from the local area minimizes building costs
- Materials are sustainable and recyclable which reduces the impact on the environment
- Effectively control air humidity for storing items that are easily affected by the environment
- High thermal mass that can absorb heat in the daytime and release it at night

## User Experience

As the users approach Adey Abeba they are met with a path that leads them to the roof where they are encouraged to climb and explore. Inside they find a large open space that allows for adaptability with the curtain tracks running along the ceiling. There is a central space that allows the users to feel secure while participating in prayer, something sacred to Ethiopian culture. Traditional patterns and appliances are used to bring a sense of familiarity to the restless refugees. This interactive space allows refugees to connect with one another in a space that feels like home while seeking security from the wars of the outside world

- LEGEND:
- Bathroom 6 m<sup>2</sup>
  - Kitchen 6 m<sup>2</sup>
  - Living space 38 m<sup>2</sup>

## Floor Plan

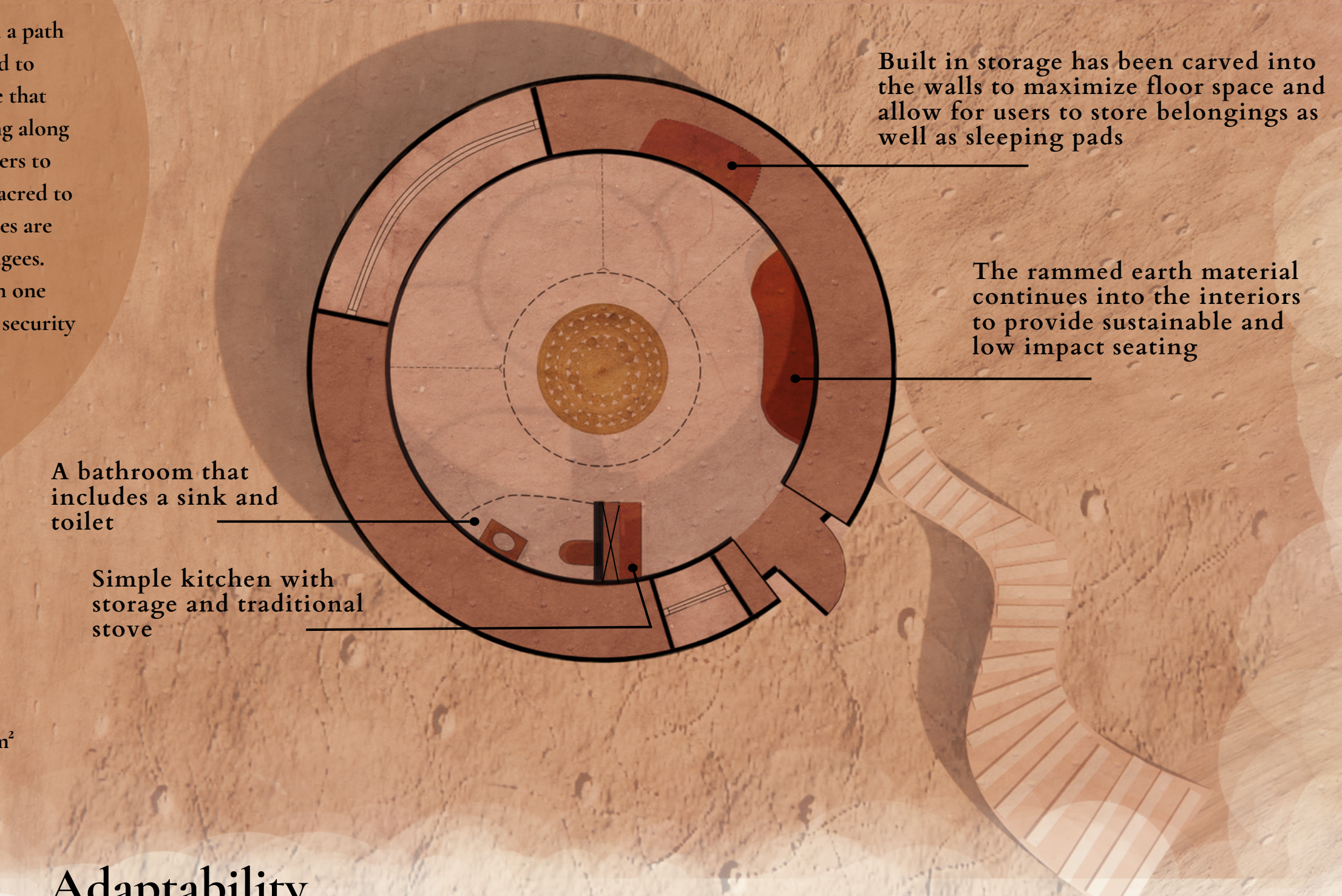

A bathroom that includes a sink and toilet

Simple kitchen with storage and traditional stove

Built in storage has been carved into the walls to maximize floor space and allow for users to store belongings as well as sleeping pads

The rammed earth material continues into the interiors to provide sustainable and low impact seating

## Adaptability

- Adapt to the site
- Adapt to accessibility
- Adapt to different privacy levels



Prayer Space

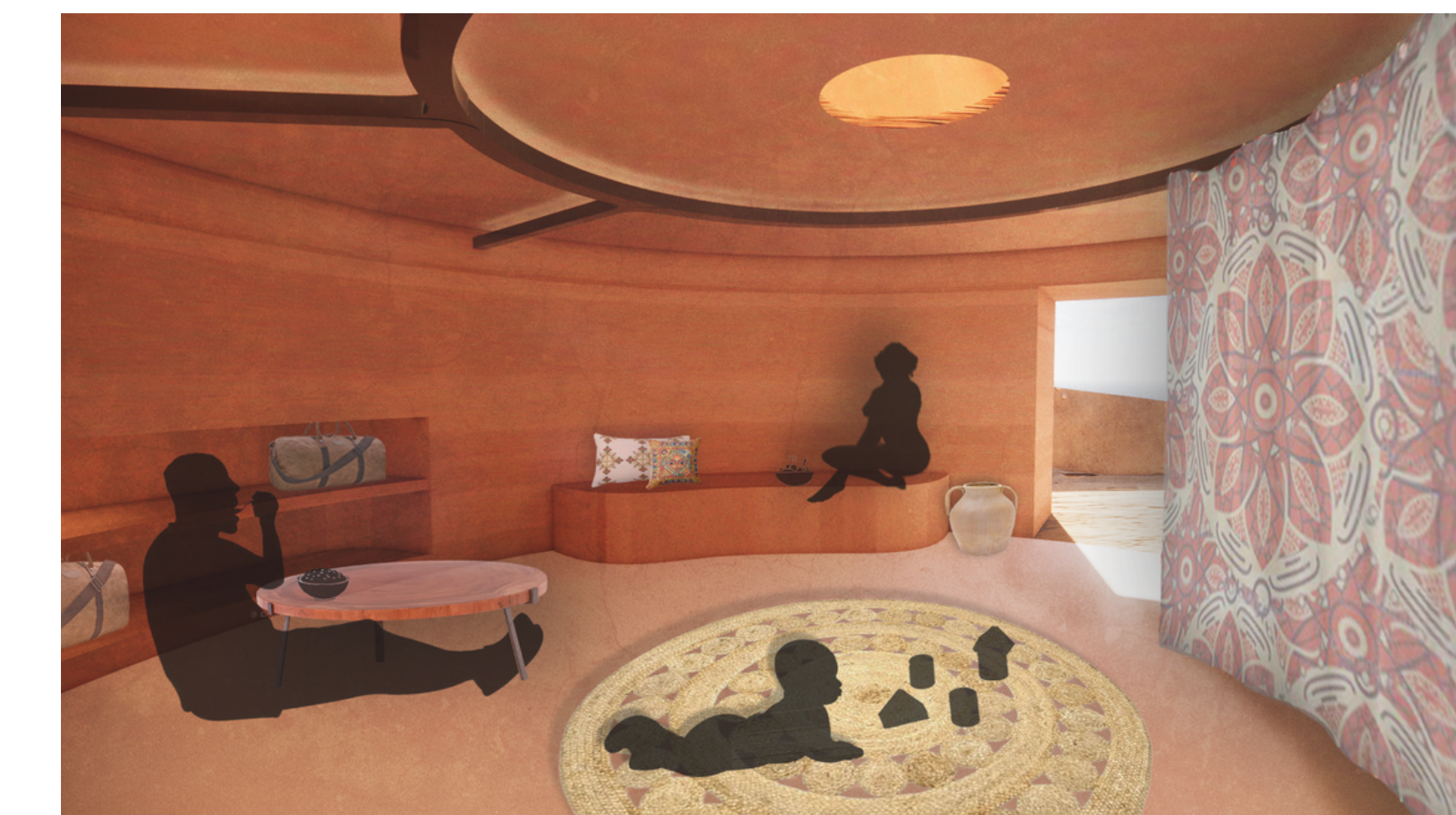

Living Space

