

Sand & Soul

Where generations learn, create, and thrive

The Concept

The driving force behind the design

Sand and Soul is a dynamic environment that nurtures **meaningful interactions** between children, young adults, and elders. Sandcastles are whimsical in nature and are often created with help from others. Based on these characteristics, the design encourages **creativity** and **collaboration** across generations, allowing visitors to engage their **inner child** and **creative spirit**. Natural elements like **plants**, **open air**, and **soothing soundscapes** promote psychological well-being. **Soft textures**, **lighting**, and **ergonomic seating** support users' physical health. The design supports activities like storytelling, art, and music, **stimulating** cognitive and creative functions, **strengthening** interpersonal relationships, and **supporting** mental and emotional health for many generations.

The Site

Vinoy Park, St. Petersburg, Florida. 701 Bayshore Dr NE.

Vinoy Park is located along the waterfront of **downtown St. Petersburg**, Florida. It is bordered by the Vinoy Renaissance Resort & Golf Club and a variety of public spaces, including North Shore Park. This prime location makes Vinoy Park a major **recreational hub** and a **focal point** for community events. The park's **open layout** makes it a popular venue for concerts, art festivals, charity walks, and cultural events. Residents and visitors also utilize the space for other activities, such as jogging, picnicking, and yoga. The park is connected to the city's **pedestrian** and **bike trail system**, making it a great area for those commuting by foot or bike. **Bus routes** are also easily accessible for those traveling by public transportation (Waterfront Parks Foundation, n.d.).

St. Petersburg experiences a **humid subtropical climate**, which includes hot, humid summers and mild winters (Weather Spark, n.d.). The city averages about **361 days of sunshine** per year, earning the nickname "The Sunshine City." However, occasional **thunderstorms** and **hurricane threats** during the summer and fall seasons require the park to be **resilient** against flooding and storm surges (Nelson Construction and Renovations, n.d.). To sustain its **long-term usability**, structures within the area must have **proper precautions** for heavy storms.

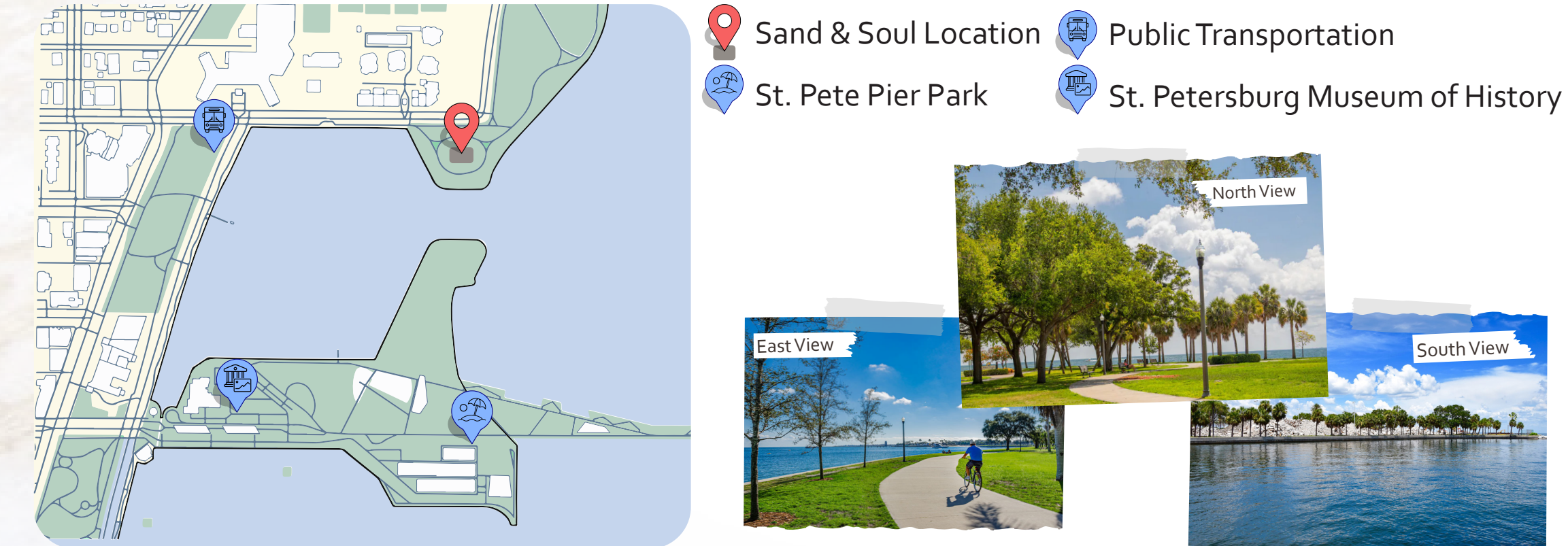

Citations

About St. Pete. St. Pete. https://www.stpete.org/visitors/about_st_pete.php#:~:text=With%20weather%20that%20sees%20averages,across%20the%20country%20and%20beyond. Climate and Average Weather Year Round in St. Petersburg. Weather Spark. <https://weatherspark.com/y/126871/Average-Weather-in-St.-Petersburg-Florida-United-States-Year-Round> BBC. (2024, May 13). Emotions and impulsive behaviour as a teenager. BBC Bitesize. <https://www.bbc.co.uk/bitesize/articles/zf9fyt> Mather, M. (2012, March). The emotion paradox in the aging brain. Annals of the New York Academy of Sciences. <https://www.ncbi.nlm.nih.gov/pmc/articles/PMC3395773/> Mental health challenges of young adults illuminated in new report. Harvard Graduate School of Education. (n.d.). <https://www.gse.harvard.edu/news/23/10/mental-health-challenges-young-adults-illuminated-new-report> Staff, S. P. (2022, April 26). The emotional lives of 8-10 Year Olds. Scholastic. <https://www.scholastic.com/parents/family-life/social-emotional-learning/development-milestones/emotional-lives-8-10-year-olds.html> Scheib, Susanne. Laura J. Carstensen, Emotional Aging: Recent Findings and Future Trends, The Journals of Gerontology: Series B, Volume 65B, Issue 2, March 2010, Pages 135-144. <https://doi.org/10.1093/geronb/65b02> U.S. Census Bureau (2022). American Community Survey 1-year estimates. Retrieved from Census Reporter Profile page for St. Petersburg, FL. <http://censusreporter.org/profiles/16000US126900-st-petersburg-fl> Vinoy Park. Waterfront Parks Foundation. (n.d.). <http://waterfrontparksfoundation.org/vinoy-park#:~:text=The%20expansive%20waterfront%20park%20provides%20an%20uninterrupted%20view> Warren, L. (2023, April 6). Zones of intimacy. Reclaiming Wisdom. <https://reclaimingwisdom.com/zones-of-intimacy/> Wilson, K. A., Gurinik, J. M., & Fried, L. P. (2023). Chair rise test: Assessing lower body function in seniors. *Journal of Gerontology: Medical Sciences*, 78(1), M33-M40. <https://doi.org/10.1093/geronm/78.1.M33> Why Are So Many Florida Homes Built With Concrete Block? Nelson Construction and Renovations. <https://nelsonconstructionrenos.com/florida-homes-concrete-block/#:~:text=This%20is%20common%20building%20practice,homes%20built%20with%20concrete%20block.>

The Story

Bridging the generational gap through design

Each stage of life resembles distinct chapters in our personal book. In the first chapter, the world feels **vast** and filled with **wonder**. We rely on our parents or caretakers to **guide us** through this adventure, they model how to navigate life, **offering lessons** that **shape our understanding** of the world. Younger generations have opportunities to **explore** the space and **experience** potentially **new activities** with older generations to guide them.

As we transition into the next chapter, everything changes. We **examine our identity**, questioning who we are and **envision the direction of our story**. While we begin to seek independence, we also face **new stresses**, **navigating challenges** that can feel overwhelming. Yet, with each bump, **we gain strength**, both physically and mentally. Young adults may find **social and mental support** that they are seeking through creative activities that can **facilitate bonding** with others close in age.

Moving into the later chapters, we often reflect on our **past experiences**, recognizing their influence on our current selves. We learn that every individual has a **unique story** to share. We learn from young children, full of energy and curiosity, reminding us of the **vitality of life**. As older adults, we have achieved an abundance of **experiences** and **wisdom**, often offering insights that influence our paths. Adults are able to participate in **creative activities**, **caregiving**, or anything in between because of their position in life. The ultimate goal of our shared journey is to **foster meaningful interactions** between these generations. By encouraging engagement and collaboration, we create opportunities for **growth**, **inspiration**, and the development of **lasting relationships**. In this way, the oldest generations find a **renewed vitality** while in the space, being able to participate in creative, **fun activities**, as well as **offering conversation** and wisdom to those who seek it.

The components needed for a sandcastle are physical, such as **sand and water**, but also abstract, such as **communication and connection**. Sand and Soul offers **unique opportunities and experiences for different generations**, while still combining various components that help to **create connections and relationships**, much like that of a sandcastle.

The User



St.Petersburg Population Data by age

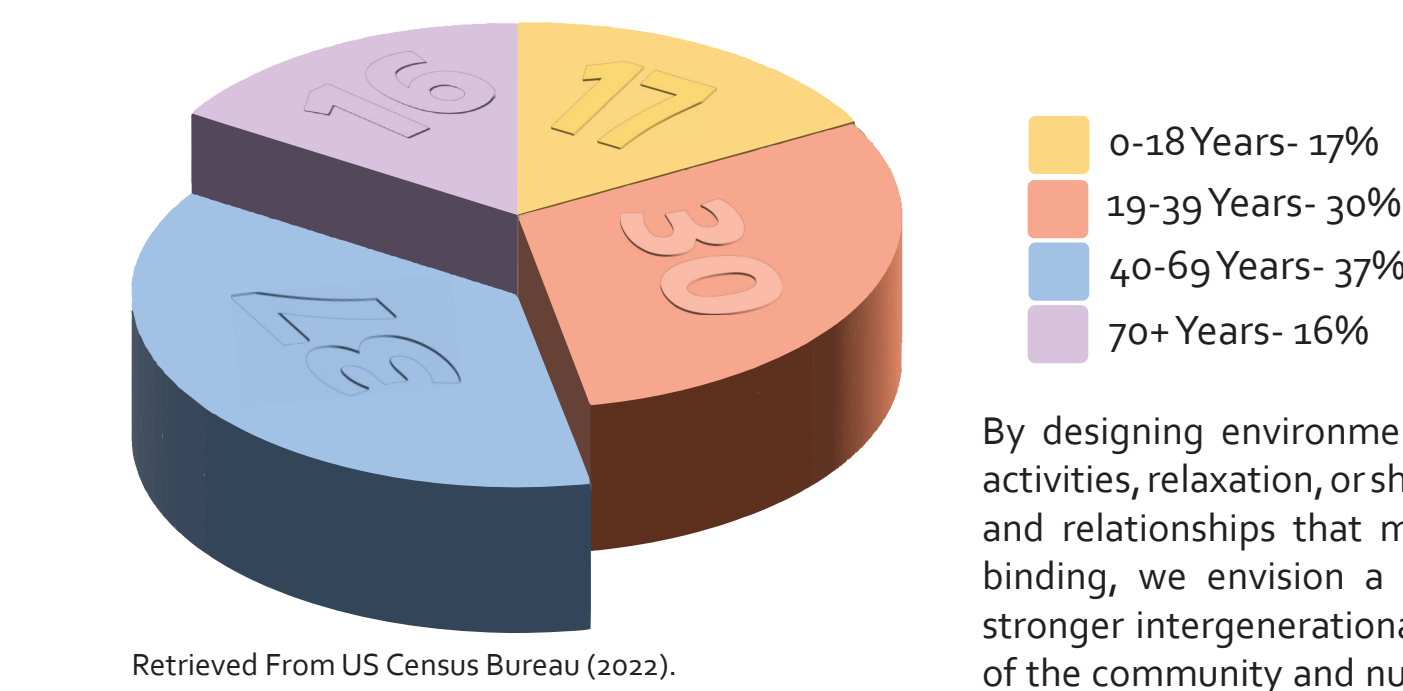

The Goals

- Establishing a welcoming, comfortable environment that caters to the needs of all generations, giving all users opportunities to interact with the space.
- Implementing areas with varying degrees of proximity in furniture arrangements, allowing users to choose their degree of intimacy with others.
- Providing activities for users to participate in that stimulates their mind and encourages interaction with other users.

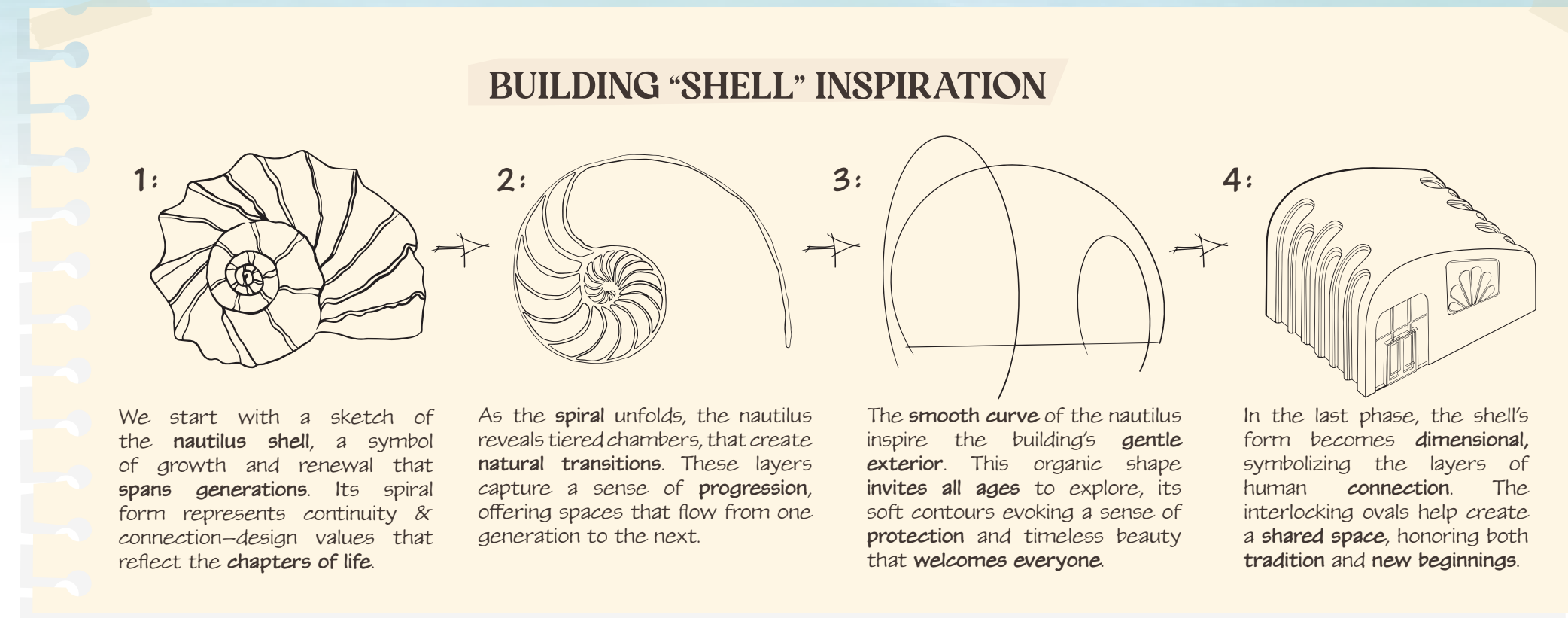

The Solution

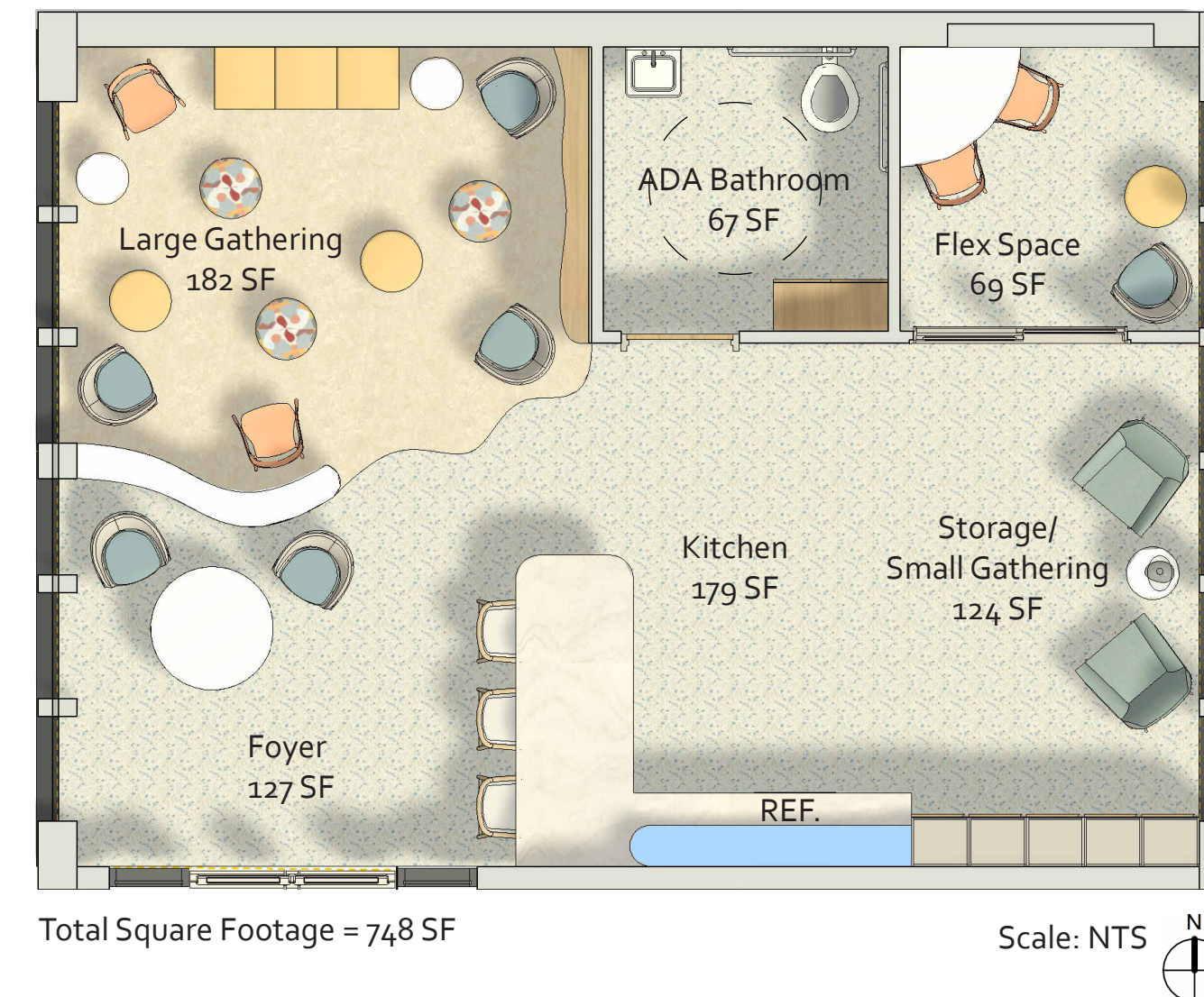

Material Considerations

Due to the warm, humid, and sometimes hurricane conditions that occur in St. Petersburg, having materials that are able to adapt and withstand the constant humidity and occasional harsh conditions is important. Due to it being located near the water, the **concrete structure** allows protection against strong winds and storm surges as well as regulates the interior temperature of the space. The **stucco exterior** is inspired by local building materials, it is a Florida favorite because of its durability and aesthetic appeal. **Hurricane-proof glass** is also implemented to withstand strong ocean winds and soften outside noise inside the space. On the interior, **luxury vinyl tile** with acoustical backing and **acoustical ceiling baffles** are utilized to mitigate noise within the concrete structure. **Performance cloth upholstery** creates a warm, comforting atmosphere for users while being durable and cleanable for long-time use and inevitable stains. **High pressure laminate** is applied on cabinets and shelving, its durability, resiliency, and cleanability is ideal for areas that endure heavy interaction. **Ocean glass terrazzo flooring** adds pops of color and allows for easy cleanability if flooding were to occur.

